



MODEL 84829 TRANSFER PUMP - "B" SERIES

1:1 RATIO, OUTPUT = 15.5 GPM

MIN AIR PRESSURE = 40 PSI

MAX AIR PRESSURE = 150 PSI

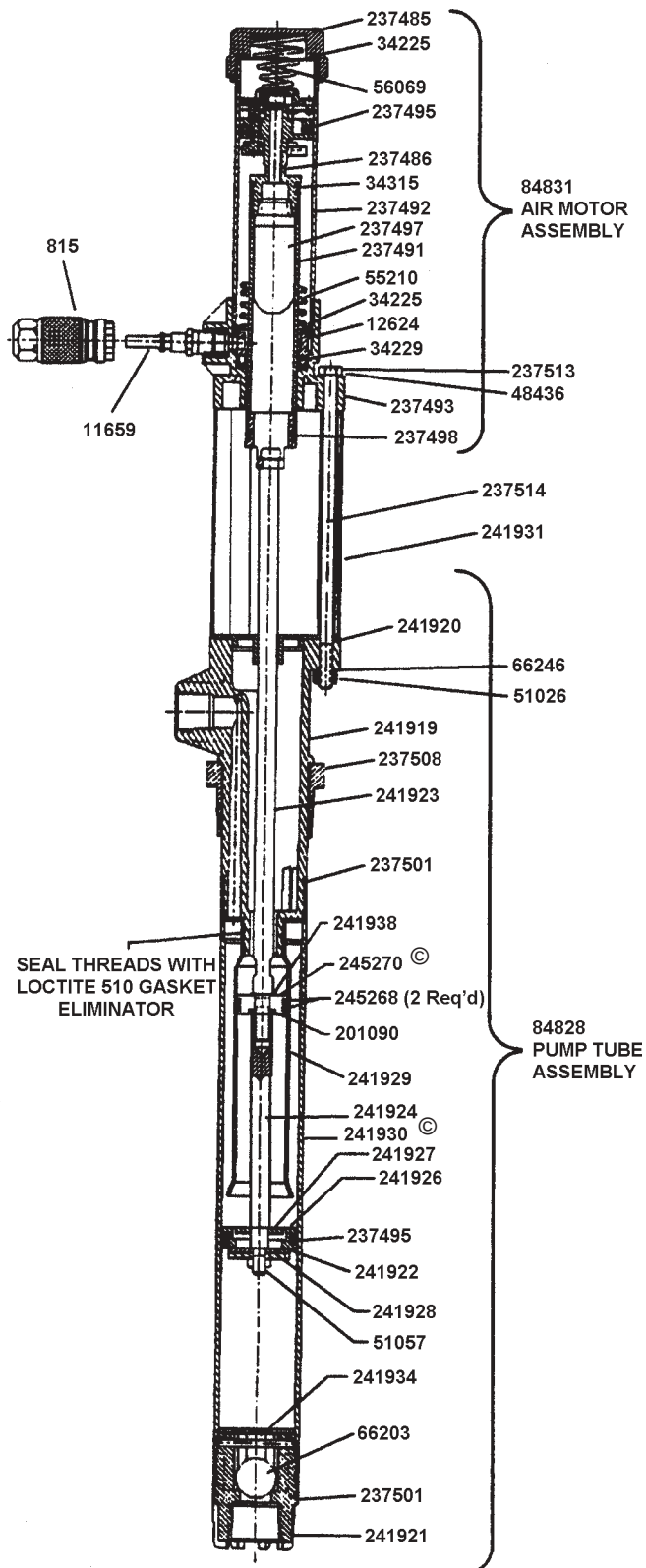

PARTS	QTY	DESCRIPTION
815	1	Air coupler
11659	1	Fitting
12624	1	Packing retainer
*34225	2	Gasket (Buna-N)
*34229	1	Packing (Buna-N)
*34315	1	O-ring
48436	3	Washer
†51026	3	Hex nut
51057	1	Hex nut
55210	1	Spring
56069	1	Spring
66203	1	Ball
66246	3	Lockwasher
84828	1	Pump tube assembly
84831	1	Air motor assembly
201090	1	Lockwasher
237485	1	Cap
237486	1	Piston assembly
237491	1	Piston rod
237492	1	Cylinder tube
237493	1	Body retainer
†*237495	2	O-ring
237497	1	Muffler
237498	1	Rod connector
†237501	2	O-ring
237508	1	Bung bushing
237513	3	Tie rod bolts
237514	3	Tie rod tube
241919	1	Outlet body
241920	1	Cup outlet body
241921	1	Foot valve
†241922	1	Check disc (Nylon)
241923	1	Rod
241924	1	Pump rod
241926	1	Piston
241927	1	Star washer
241928	1	Washer
241929	1	Sleeve
241930	1	Pump tube
241931	1	Piston rod cover
241934	1	Ball retainer pin
© 241937	1	Extension tube (not shown)
†241938	1	Gasket (copper)
†245268	2	U-cup (Hytrel)
© 245270	1	Piston

* Included in Service Kit 84836

† Included in Service Kit 84838

84836 Air Motor Service Kit

84838 Pump Tube Service Kit

© Indicates change

PRESSURE RELIEF PROCEDURE

Always perform this procedure when the pump is shut off and before checking, servicing, installing, cleaning or repairing any part of this system.

Perform the following procedure:

- A. Disconnect air supply to the pump.
- B. Point dispensing valve away from yourself and others.
- C. Open dispensing valve into an appropriate container until the pressure is relieved.

If the above procedure does not relieve the pressure, the dispensing valve or hose may be restricted. To relieve the pressure, very slowly loosen the hose end coupling. Then loosen completely and clear the dispensing valve and/or hose.

MATERIAL RESTRICTION PREVENTION

Flush the system as required with a compatible solvent to prevent material buildup when pumping material that dries or hardens.

CORROSION PREVENTION

WARNING

To reduce the risk of injury from splashing or static sparking when flushing the pump with solvents, always hold a metal part of the dispensing valve firmly to the side of a grounded metal pail and operate pump at lowest possible fluid pressure.

To prevent water or air corrosion, never leave the pump filled with water or air. Flush the pump first with a compatible solvent and then again with mineral spirits or oil based solvent.

TROUBLESHOOTING

If the following procedures do not correct the problem, contact a factory authorized service center. When submitting equipment to be repaired, be sure to state the nature of the problem and indicate if a repair cost estimate is required.

PROBLEMS

AIRMOTOR DOES NOT OPERATE.

- Check air supply to pump.
- Check control valve or hose for blockage.
- Replace piston assembly (237486).

AIR SEEPAGE FROM AIR EXHAUST WHILE PUMP IS NOT OPERATING

- Replace O-ring (34315).
- Replace piston assembly (237486).

LOSS OF PRESSURE, VOLUME OR CONTINUOUS OPERATION OF PUMP WHEN NOT IN NORMAL USE.

- Check O-Ring (237495) for wear.

- Inspect pump tube (241930) to ensure area where O-ring (237495) travels is not scored or rough.
- Check foot valve to ensure proper seating of the ball (66203).

EXCESSIVE AMOUNT OF LUBRICANT COMING FROM BYPASS HOLE LOCATED JUST BELOW BUNG BUSHING.

- Seal sleeve (241929) with Loctite 510 gasket eliminator.
- Replace gasket (241938) or U-cup (245268).

DISASSEMBLY

WARNING

To prevent personal injury, perform PRESSURE RELIEF PROCEDURE before and after operating the pump and before performing any disassembly or assembly.

AIRMOTOR REMOVAL

WARNING

To prevent personal injury, disconnect air supply from pump before removing piston rod cover (241931).

DO NOT operate pump with cover removed. Cover must be replaced when reinstalling air motor.

- A. Unscrew tie rod nuts (51026) and remove tie rod bolts (237513), and tie rod tubes (237514), washers (48436) and lockwashers (66246).
- B. Lift airmotor and unhook rod connector (237498) from pump rod (241923). Remove the piston rod cover (241931).

AIRMOTOR DISASSEMBLY

- A. Remove airmotor assembly (84831) from pump tube.
- B. Unscrew cap (237485) and remove spring (56069) and gasket (34225).
- C. Unscrew cylinder tube (237492) and lift off of piston assembly.
- D. Pull piston assembly (237486) and piston rod (237491) out through upper end of airmotor body (237493) and remove spring (55210).
- E. Unscrew piston assembly (237486) from piston rod (237491) remove O-rings (34315) and (237495) and unscrew muffler (237497).
- F. Remove gasket (34225), packing retainer (12624) and packing (34229) from body retainer (237493).

PUMP TUBE DISASSEMBLY

- A. Remove airmotor assembly (84831) from pump tube.
- B. Remove cup (241920) from outlet (241919).

- C. Unscrew foot valve (241921) from pump tube (241930) and remove O-ring (237501), pin (241934) and ball (66203).
- D. Unscrew pump tube (241930) from outlet body (241919) and pull downward over lower piston and remove O-ring (237501).
- E. Pull pump rod (241924) and lower piston through the lower end of the outlet body (241919) and sleeve (241929).
- F. Unscrew nut (51057) from pump rod (241924) to remove washer (241928), check disc (241922), O-ring (237495), piston (241926) and starwasher (241927).
- G. Unscrew pump rod (241924) from rod (241923) to remove washer (201090), U-cups (245268), piston (242270) and copper gasket (241938).

ASSEMBLY

To reassemble, perform DISASSEMBLY procedures in reverse. Lubricate the air cylinder tube (237492), fluid pump tube (241930), piston rod (237491) and rod (241923) before assembly.

© To adapt for 55 gal. container, attach extension tube (241397) to foot valve (241921).

REPAIR

Repair is limited to replacement of listed service parts. Special procedures and tools are required. Contact Lincoln Customer Service, One Lincoln Way, St. Louis, MO 63120-1578, (314) 679-4200 for your nearest authorized service center.

When ordering replacement parts, list: part number, description, model number and series letter.

LIMITED WARRANTY-

Lincoln warrants the equipment it supplies to be free from defects in material and workmanship for one (1) year following the date of purchase. If equipment proves to be defective during this warranty period it will be repaired or replaced, at Lincoln's discretion, without charge provided that factory authorized examination indicates the equipment to be defective. To obtain repair or replacement, you must ship the equipment, transportation charges prepaid, with proof of date of purchase to a Lincoln authorized warranty and service center, within one (1) year following the date of purchase.

LIMITED 5 YEAR WARRANTY (Series 20, 25, 40 Bare Pumps, Heavy Duty and Golden Standard Bare Reels)-

Lincoln warrants series 20, 25, 40 bare pumps, and heavy duty and golden standard bare reels it supplies to be free from defects in material and workmanship for one (1) year following the date of purchase. If equipment proves to be defective during the warranty period it will be repaired, or replaced, at Lincoln's discretion, without charge provided that factory authorized examination indicates the equipment to be defective. To obtain repair or replacement, you must ship the equipment, transportation charges prepaid, with proof of purchase to a Lincoln Authorized Warranty and Service Center within one (1) year following the date of purchase. Additionally, in years two (2) and three (3) the warranty on this equipment is limited to repair with Lincoln paying parts and labor only. In years four (4) and five (5), the warranty on this equipment is limited to repair with Lincoln paying for parts only.

This warranty is extended to the original retail purchaser only. It does not apply to equipment damaged from accident, overload, abuse, misuse, negligence, faulty installation or abrasive or corrosive material, or to equipment repaired or altered by anyone not authorized by Lincoln to repair or alter the equipment. This warranty applies only to equipment installed and operated according to the recommendations of Lincoln or its authorized field personnel. No other express warranty applies.

Any implied warranties applicable to equipment supplied by Lincoln, including the warranties of merchantability and fitness for a particular purpose, will last for only one (1) year from the date of purchase. Some jurisdictions do not allow limitations on how long an implied warranty lasts, so the above limitation may not apply to you.

In no event shall Lincoln be liable for incidental or consequential damages. Lincoln's liability on any claim for loss or damages arising out of the sale, resale or use of equipment it supplies shall in no event exceed the purchase price. Some jurisdictions do not allow the exclusion or limitation of incidental or consequential damages, so the above limitation or exclusion may not apply to you.

© Indicates change

Americas: One Lincoln Way St. Louis, MO 63120-1578 USA Phone +1.314.679.4200 Fax +1.800.424.5359	Europe/Africa: Heinrich-Hertz-Str 2-8 D-69183 Walldorf Germany Phone +49.6227.33.0 Fax +49.6227.33.259	Asia/Pacific: 25 Int'l Business Park #01-65 German Centre Singapore 609916 Phone +65.562.7960 Fax +65.562.9967	© Copyright 2004 Printed in USA Web site: www.lincolnindustrial.com
-----------------------------------------------------------------------------------------------------------------	-----------------------------------------------------------------------------------------------------------------------	-------------------------------------------------------------------------------------------------------------------------------	----------------------------------------------------------------------------------