

Owner/operator Responsibility

It is the owner/operator responsibility to properly use and maintain this equipment.

The instructions and warnings contained in this manual shall be read and understood by the owner/operator prior to operating this equipment.

If an owner/operator does not understand english, the contents of this manual shall be explained in the owner/operator native language to assure the owner/operator comprehends.

It is the owner/operator responsibility to maintain the legibility of all warning and instruction labels.

The owner/operator shall retain this manual for future reference to important warnings, operating and maintenance instructions.

Description:

Grease filler pump is an ideal grease filling solution to easily load bulk or combination Grease guns from bulk grease containers

Specifications:

Fits : 25 - 50 lbs / 5 gallons / 20 liter barrels.
Delivery : 1 oz. (28 gms.) Per strokes©
Drum cover diameter - 12" (310 mm)
Pump length - 18" (457 mm)

The pump comes complete with Drum Cover, Follower Plate, and two filler adapters one for the Lincoln brand filler fitting and one for the Guardian Brand filler fitting.

© Indicates change

MODEL 1296
MANUAL FILLER PUMP
Series "C"

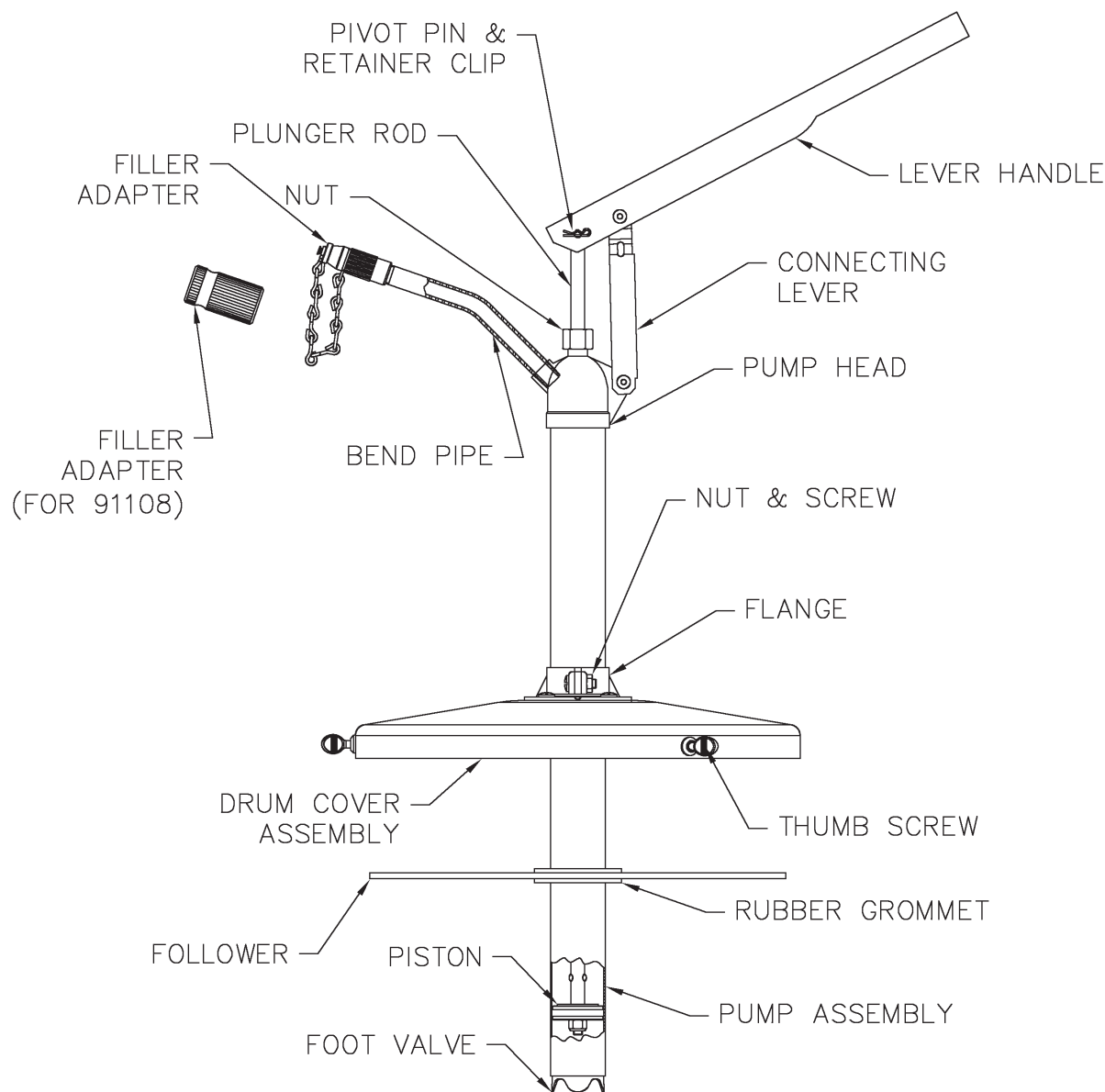

Assembly & Operation

1. Insert the pump assembly through the flange fitted on the drum cover assembly.
Note: do not tighten the nut & screw to clamp the tube assembly with drum cover assembly.
2. Insert the follower plate in grease container. Push down firmly onto the grease until grease emerges through the rubber grommet.
3. Insert the pump tube assembly along with the drum cover through the rubber grommet of follower plate, till the pump tube touches the base of the container.
4. Adjust the drum cover on the pump tube assembly to ensure it seats firmly on to the rim of grease container.

5. Hand tighten the 3 thumb screws on the drum cover. Assembly attach the drum cover firmly on the grease container.
Note: take care to tighten the thumb screws evenly on to the grease container.
6. Tighten the nut & screw on the flange of the drum cover to hold the tube assembly firmly in place.
Note: do not over tighten the nut & screw assembly.
7. Screw the grease bend pipe and filler adapter assembly on to the outlet at the pump head.

The pump is now ready, start the pump by moving the lever handle up as high as it will go then down, material should begin to flow after just a few strokes. If not the pump needs priming, put some oil in the outlet of the pump and start operating the lever handle.

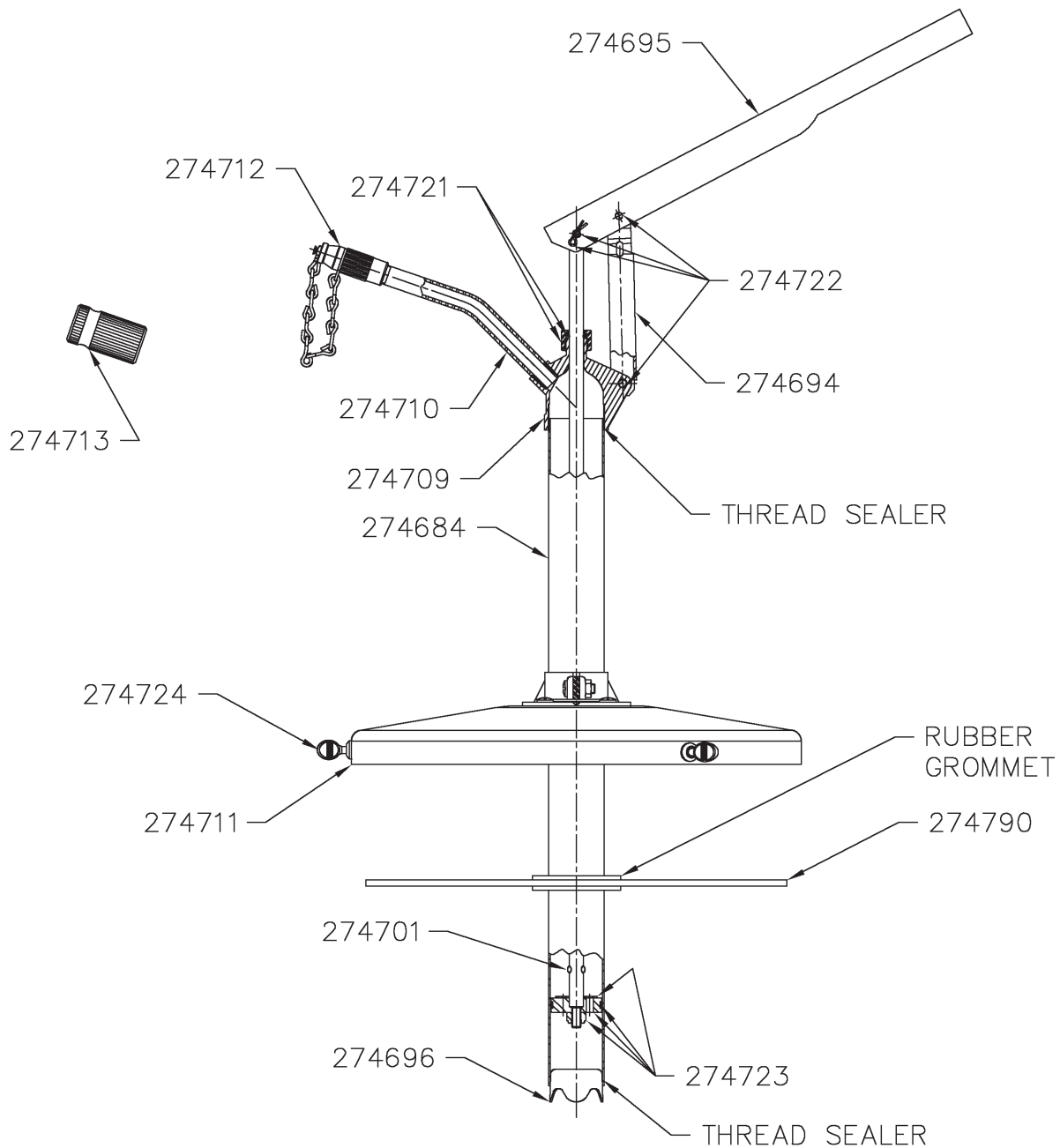

Parts Required

Part	Description	Qty	Part	Description	Qty
274684	Pump Tube Assembly	1	274711	Drum Cover Assembly	1
274694	U-Clip	1	274712	Filler Adapter (for 91108)	1
274695	Handle	1	274713	Filler Adapter (for G907)	1
274696	Follower Cap Assembly	1	274721	Kit Cap & O-Ring	1
274701	Plunger Rod	1	274722	Kit Pin & Rivit	1
274709	Head	1	274723	Kit Plunger	1
274710	Bent Tube	1	274724	Kit Thumb Screw	1

MODEL 1296

MANUAL FILLER PUMP

Series "C"



Troubleshooting

Problem	Cause	Remedy
Hard to pump	Gland nut is screwed down too tight.	Adjust gland nut.
	Bent Piston Rod.	Replace Piston Rod and Piston Assembly.
Pump fails to prime.	Footvalve Ball is not sealing.	Remove and clean Footvalve. Reassemble the Footvalve using pipe sealing on threads.
	Piston Valve is damaged and is not seating.	Replace Piston and Piston Rod Assembly.



WARNING

Failure to heed the following warnings including misuse, modifying parts, using incompatible Chemicals and fluids, or using worn or damaged parts, may result in equipment damage and/or serious personal injury, fire, explosion, or property damage.

- Do not alter or modify any part of this equipment.
- Make sure the pump and all other equipment used or located in the pumping area are grounded.
- Do not use the pump if any static sparking or electrical shock occurs. Stop pumping immediately and do not use the pump until the problem is corrected.
- Make sure all fluid connections are securely tightened before using this equipment.
- Always read and follow the fluid manufacturers recommendations regarding fluid compatibility, and the use of protective clothing and equipment.
- Check all equipment regularly and repair or replace worn or damaged parts immediately.

Lincoln Industrial Standard Warranty

LIMITED WARRANTY

Lincoln warrants the equipment manufactured and supplied by Lincoln to be free from defects in material and workmanship for a period of one (1) year following the date of purchase, excluding there from any special, extended, or limited warranty published by Lincoln. If equipment is determined to be defective during this warranty period, it will be repaired or replaced, within Lincoln's sole discretion, without charge.

This warranty is conditioned upon the determination of a Lincoln authorized representative that the equipment is defective. To obtain repair or replacement, you must ship the equipment, transportation charges prepaid, with proof of purchase to a Lincoln Authorized Warranty and Service Center within the warranty period.

This warranty is extended to the original retail purchaser only. This warranty does not apply to equipment damaged from accident, overload, abuse, misuse, negligence, faulty installation or abrasive or corrosive material, equipment that has been altered, or equipment repaired by anyone not authorized by Lincoln. This warranty applies only to equipment installed, operated and maintained in strict accordance with the written specifications and recommendations provided by Lincoln or its authorized field personnel.

THIS WARRANTY IS EXCLUSIVE AND IS IN LIEU OF ANY OTHER WARRANTIES, EXPRESS OR IMPLIED, INCLUDING, BUT NOT LIMITED TO, THE WARRANTY OF MERCHANTABILITY OR WARRANTY OF FITNESS FOR A PARTICULAR PURPOSE.

In no event shall Lincoln be liable for incidental or consequential damages. Lincoln's liability for any claim for loss or damages arising out of the sale, resale or use of any Lincoln equipment shall in no event exceed the purchase price. Some jurisdictions do not allow the exclusion or limitation of incidental or consequential damages, therefore the above limitation or exclusion may not apply to you.

This warranty gives you specific legal rights. You may also have other rights that vary by jurisdiction.

Customers not located in the Western Hemisphere or East Asia: Please contact Lincoln GmbH & Co. KG, Walldorf, Germany, for your warranty rights.

Lincoln Industrial Special Limited Warranties

SPECIAL LIMITED 2 YEAR WARRANTY

SL-V Series, Single Injectors-85772, 85782, and Replacement Injectors-85771, 85781

Lincoln warrants the SL-V Injector series to be free from defects in material and workmanship for two (2) years following the date of purchase. If an injector model (single or replacement) is determined to be defective by Lincoln, in its sole discretion, during this warranty period, it will be repaired or replaced, at Lincoln's discretion, without charge.

SPECIAL LIMITED 5 YEAR WARRANTY

Series 20, 25, 40 Bare Pumps, Heavy Duty and 87000 Series Bare Reels

Lincoln warrants series 20, 25, 40 bare pumps, and Heavy Duty and 87000 series (87300, 87500, 87700) bare reels to be free from defects in material and workmanship for five (5) years following the date of purchase. If equipment is determined by Lincoln, in its sole discretion, to be defective during the first year of the warranty period, it will be repaired or replaced at Lincoln's discretion, without charge. In years two (2) and three (3), the warranty on this equipment is limited to repair with Lincoln paying parts and labor only. In years four (4) and five (5), the warranty on this equipment is limited to repair with Lincoln paying for parts only.

Americas:

One Lincoln Way
St. Louis, MO 63120-1578
USA
Phone +1.314.679.4200
Fax +1.800.424.5359

Europe /Africa/Middle East

Lincoln GmbH
Heinrich-Hertz-Str. 2-8
69190 Walldorf - Germany
Phone/Fax +49.6227.33-0/-259
www.lincolnindustrial.de

Asia/Pacific:

51 Changi Business Park
Central 2
#09-06 The Signature
Singapore 486066
Phone +65.6588.0188
Fax +65.6588.3438

© Copyright Lincoln Industrial Corp.
2008

Printed in USA

Web site:
www.lincolnindustrial.com